



4 St Claire Gardens Atwell WA

3  1  2 

Welcome to a gardener's paradise, perfect for families and workshop enthusiasts alike! This charming three-bedroom, one-bathroom home in Atwell is a fantastic opportunity for first-time buyers or those looking to downsize. With an expansive outdoor space featuring an entertainer's patio, a generous lawn, established fruit trees, and a powered workshop, this property has it all.

Set on a spacious 650sqm block, you'll find yourself ideally located between Atwell Primary and Cockburn Train Station, just minutes from the Kwinana Freeway and local amenities.

As you arrive, you're greeted by a delightful front garden and a double carport leading to a winding paved path. Step

[For full version visit the website](https://www.thriverealestate.com.au)

Type : House
Price : UNDER CONTRACT!
Land Size : 650 sqm
View : <https://www.thriverealestate.com.au/sale/wa/southern-suburbs/atwell/residential/house/8171165>



Derick Pitt
08 9414 9440

4 St Claire Gardens, ATWELL

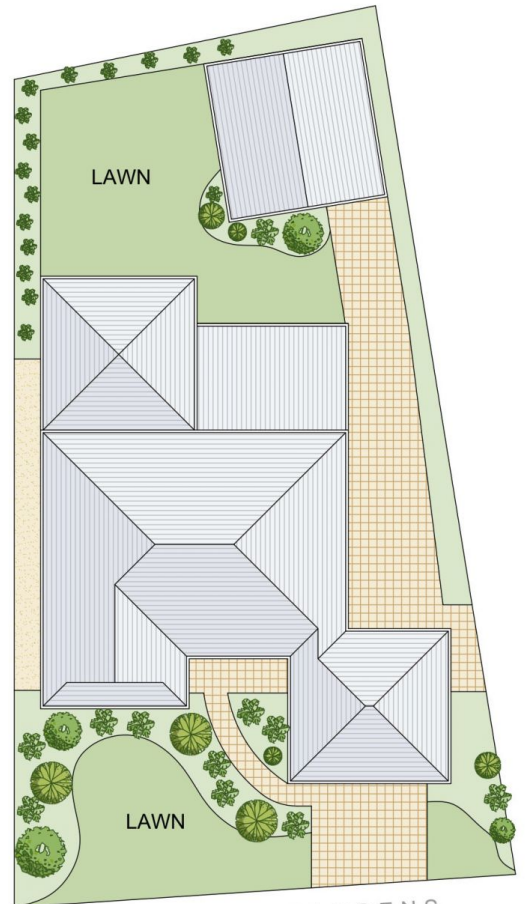
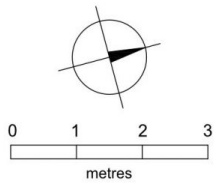

SITE PLAN
(NOT TO SCALE)

